

Limit Switch YT-850

Ordering Symbols: YT-850 ■ ■ ■

Model	Switching Type	Connection Type	Bracket Type
YT-850	M Mechanical Type	1 NPT 1/2	1 ST-1 (30*80,H20)
	R Proximity	2 PT 1/2	2 ST-2 (30*80,H30)
		3 PF 1/2	3 ST-3 (30*130,H30)
		4 M20	4 ST-4 (30*130,H50)
		5 PG13.5	



Specifications

Item.Type	YT-850M	YT-850P
Switch Type	Mechanical Switch x2	Proximity Sensor x 2
Switch Rating	AC:250V 3A,125V 5A DC:250V 0.2A,125V 0.4A,30V 4A	12~24V DC (Operating Voltage: 10~30v DC)
Enclosure Protection	Weather proof, IP67 / NEMA4&4X	
Ambient Temp.	-20 °C ~80 °C	
Conduit Entry	NPT1/2,(PT1/2,PF1/2,M20,PG13.5)	
Terminal	8Points	
Mouting Bracket	NAMUR VDI / VDE 3845, ISO5211	
Material	Aluminum	
Weight	880g(1.94lb)	

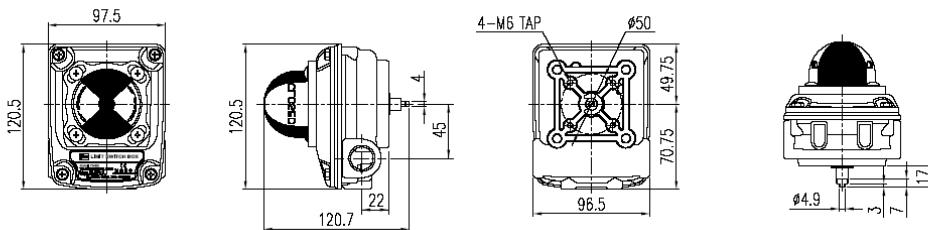

- Visual position indicator.
- Limit switch adjustment cams has spring. Changing cam position is very simple without requiring any tools. (close-up, open-down)
- Terminal strip number with 8 contacts is standard for micro-switches.
- Solenoid valve can be connected easily.
- Dual 1/2" conduit entries.
- It is designed to be captive by the cover.
- Can be mounted on any rotary actuator in ISD5211.