

Pneumatic- Pneumatic Positioner YT-1200R (Rotary Type)

Ordering Symbols: YT-1200R



Model	Acting Type	Lever Type	Orifice Type	Connection Type	Ambient Temp
YT-1200R	Single Acting	M6×40L	φ1	PT	-20℃~70℃
	Double Acting	M6×63L	φ2	NPT	-20℃~120℃
		M8×40L	NONE		-40℃~70℃
		M8×63L			
		NAMUR			



Specifications

Item.Type	Single	Double
Input Signal	0.2~1kgf/cm ² (3~15psi)	
Supply Pressure	1.4~7kgf/cm ² (20~100psi)	
Stroke	0~90°	
Air Connection	PT (NPT) 1/4	
Gauge Connection	PT (NPT) 1/8	
Protection	IP66	
Ambient Temp	-20~70℃ (-4~158°F)	
Linearity	±2% F.S.	
Hysteresis	±1% F.S.	
Sensitivity	±0.5% F.S.	
Repeatability	±0.5% F.S.	
Air Consumption	3LPM(Sup=1.4kgf/cm ² , 20psi)	
Flow Capacity	80LPM(Sup=1.4kgf/cm ² , 20psi)	
Material	Aluminum Diecasting	
Weight	1.7kg(3.1lb)	

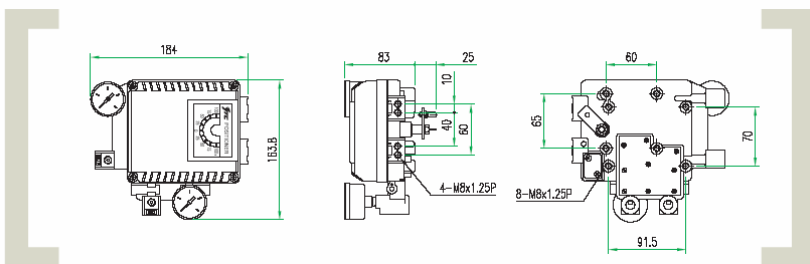

The Pneumatic Positioner, YT-1200R, is used for pneumatic rotary valve actuators by means of pneumatic controller or control systems with an output signal of 3 to 5 psi or split ranges.

- Size is compact.
- The change of RA/DA action is convenient, and it is applicable to single or double acting actuator.
- It is possible to prevent the hunting with orifice to the small size actuator.
- It is economical due to less air consumption.
- It is able to control the 1/2 split range with simple modification without part replacement.